

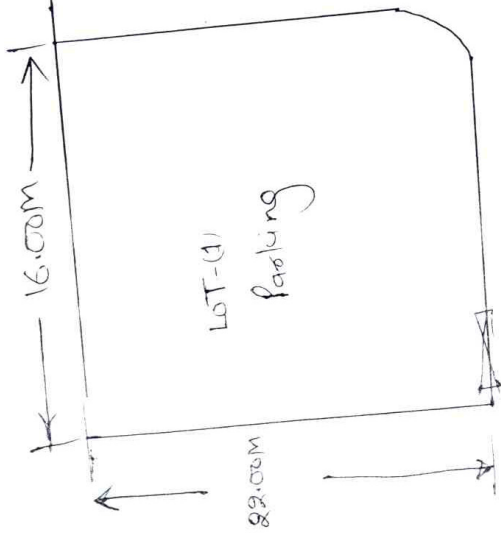

PARKING SITE AT
GHITORI STATION

New site



Kirti Nagar - II
Station Building

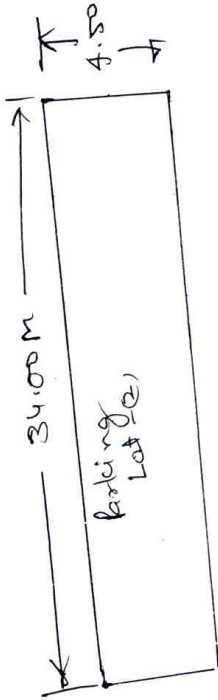

$$\text{Area Lot - (E) (II)} = 352.00 + 153.00 \\ = \underline{\underline{505.00 \text{ sqm}}}$$

15/6/11
15/6/10

$$A+B = \underline{\underline{1345.46 \text{ sqm}}}$$

$$\text{Total Old + New parking} = \underline{\underline{1345.46 \text{ m}^2}}$$

old parking
840.00 m²

5

Date: 14/07/07



July

12/10/07

Kirti Nagar

Jointly measured the parking area of KNR Stn.

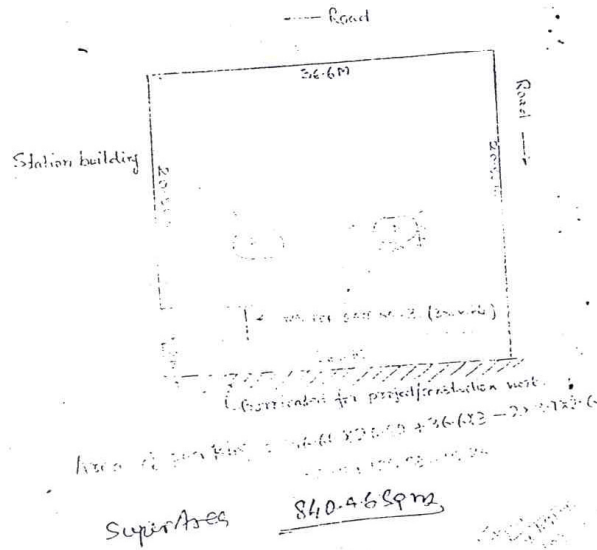

Mehar Kaur
Proprietor